



# Y1005

## Y1000 Desk Kit

The Desk Kit is specifically designed for use with the F2R y1000 device.

### Desk Stand Assembly:

1. Remove the O-ring from the support Plate.
2. Reinsert the support plate into the Base plate.
3. Insert the O-ring in the support plate to secure it to the base plate.
4. You can now place your Y1000 on the desk stand.

### Power Plug Assembly:

1. Select the appropriate plug adapter from your region and insert it into the main power adapter body.
2. Connect the red power connector from the power plug to the red connector on the Y1000.
3. Your Desk Kit is now ready to use.

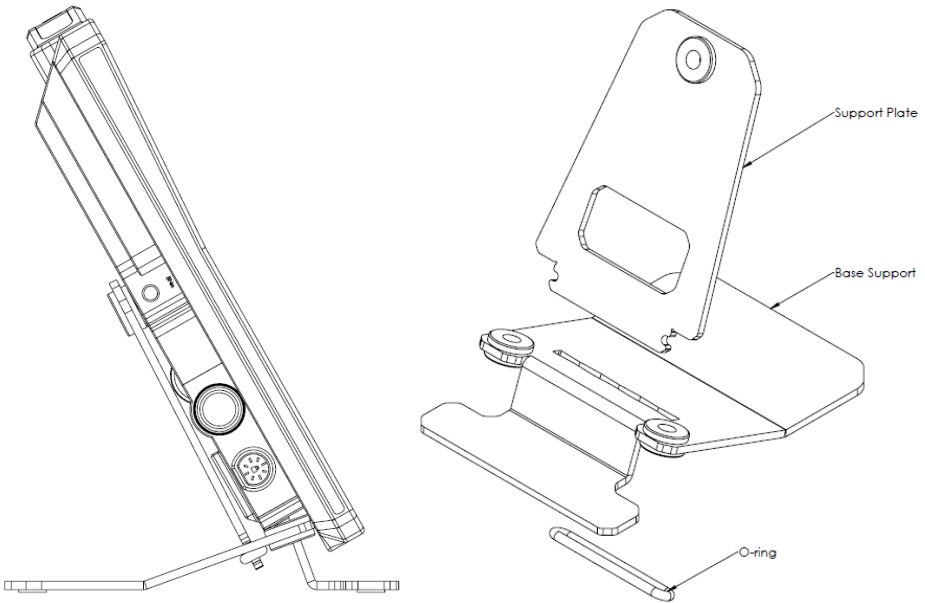

### Package Includes:

- 1 x Aluminum desk stand with Anti-Slip pads
- 1 x Power adapter with Interchangeable plugs: EU, UK, US, and AUS

### Warning:

Tampering with this product will **void the warranty**, as it may cause malfunctions and damage to the **Y1000 device**.

### Note:

Due to the Y1000 power management system, the following behavior will occur when no movement is detected:

- Brightness is reduced after 2 minutes.
- The display turns off after 5 minutes.
- The device powers off completely after 60 minutes.